

## Surfa KnifeEdge 4 in. - Fixture

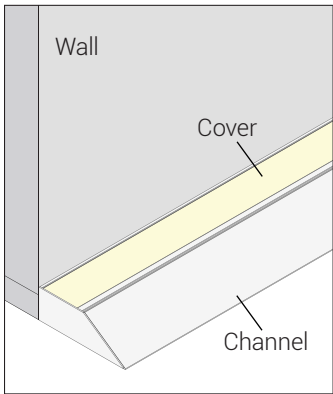

1. Before installing the tape light in the channel, test the connection to power. If using a full spool of tape, connect one end of the tape to DC power and turn power on. If using a cut section of tape, attach the connector to the tape and then connect to DC power.
2. Position the 24V DC Class 2 power supply in a suitable location within 30 feet of the desired fixture location.

Note: Longer distances are acceptable when using a thicker 12 AWG wire.

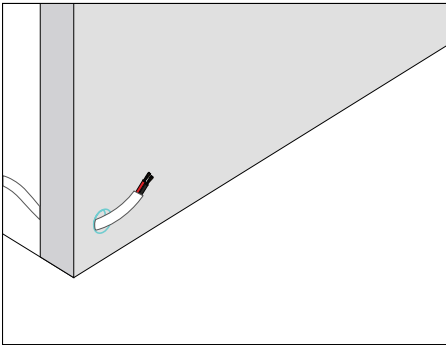

3. Bring power to a point through the wall that will match the position of the fixture's cable conduit.

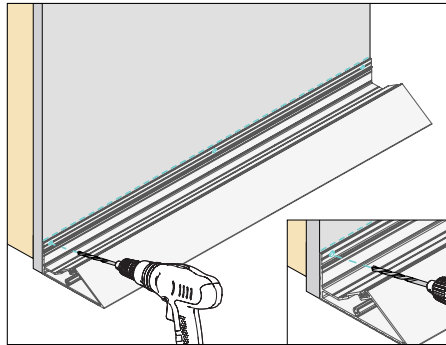

4. Drill 3/16 in. mounting holes along the drill port in the fixture to match the stud locations in the wall. Deburr any sharp edges.

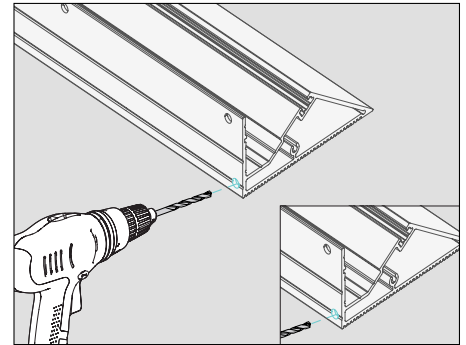

5. Drill a 1/4 in. hole through the back of the fixture this will be used for the power feed. Deburr any sharp edges.

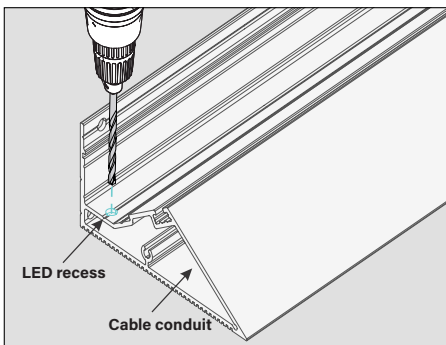

6. Drill a 11/64 in. hole through the floor of the LED recess into the cable conduit to provide wire access from the LED recess. Deburr any sharp edges.

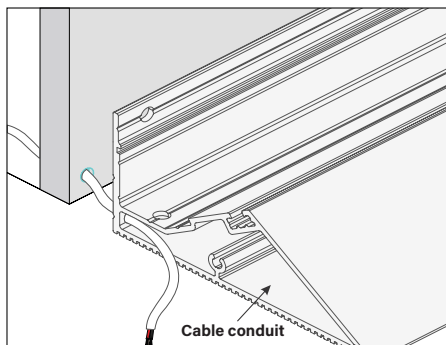

7. Pass the DC power cable through the 1/4 in. hole on the back into the cable conduit.

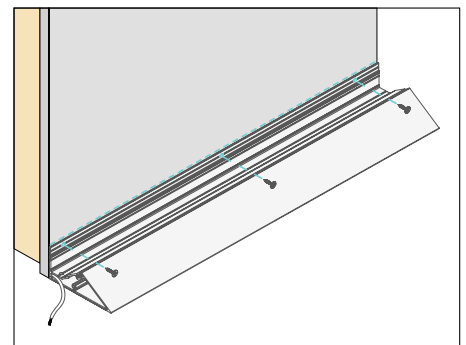

8. Place the fixture against the drywall panel and secure it with standard drywall screws into the 3/16 in. holes aligned with the stud locations in the wall.

## Surfa KnifeEdge 4 in. - Fixture

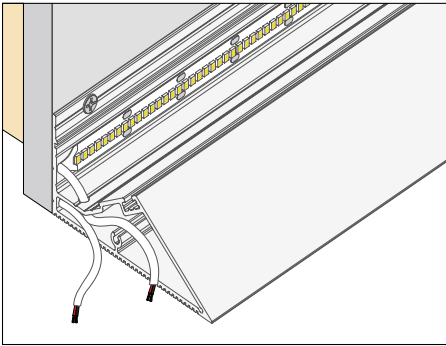

9. Remove the adhesive backing from the back of the LED tape. Apply the tape where shown. Pass the lead wire through the 11/64 in. hole into the cable conduit.

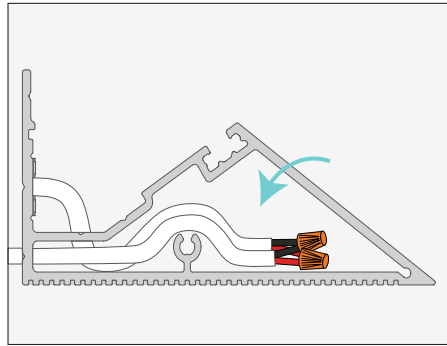

10. Connect LED tape lead to low-voltage in-wall rated wire. Red is positive (+) and black is negative (-). Place the wires in the cable conduit.

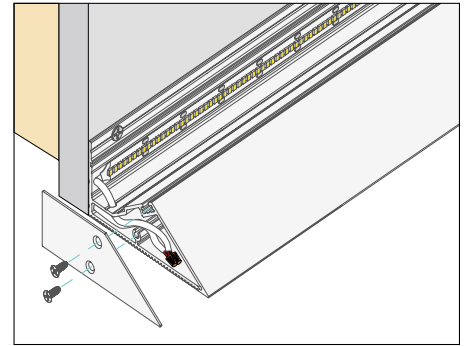

11. Assemble each end cap at the ends of Surfa KnifeEdge with two flat head screws provided.

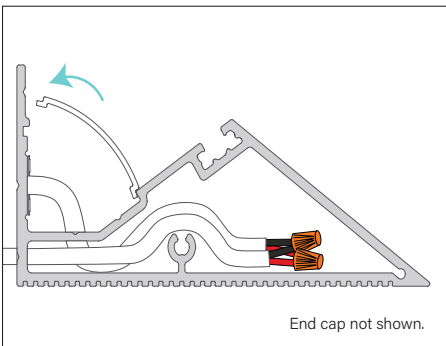

12. Test that the LEDs are working correctly before proceeding, then install the LED diffuser.

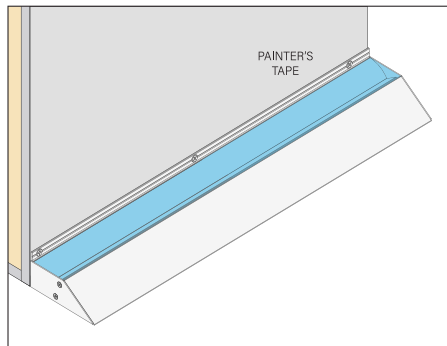

13. Cover the inside of the fixture with painter's tape if necessary before plastering, to prevent joint compound and dust from entering.

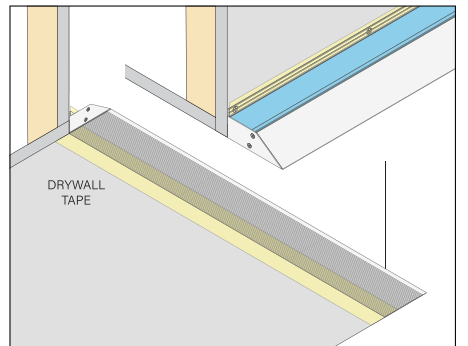

14. Apply drywall tape along the edges of the fixture to prevent the joint compound from cracking after installation, and smooth the tape flush.

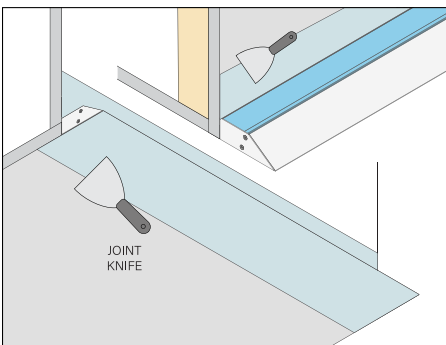

15. Apply joint compound mud to the mud-in flanges with a joint knife, covering the flanges and screw heads, and smooth the mud joint.

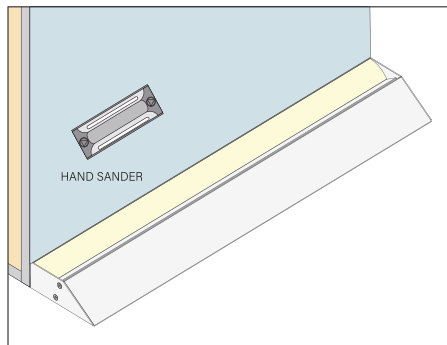

16. Once dry, use the hand sander to smooth the mud to make a seamless look with the drywall. Then remove the painter's tape.

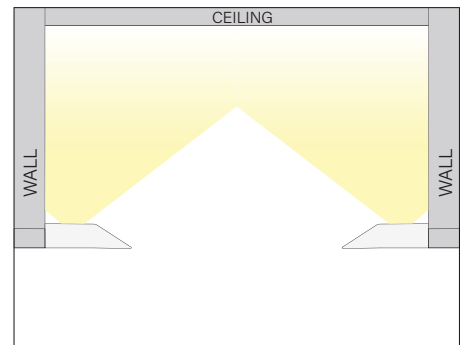

17. Paint or finish the wall as desired. Turn on lights.