

# ALLOY LED<sup>®</sup> Installation Instructions

## Surfa<sup>®</sup> Cornice 4in. - Channel

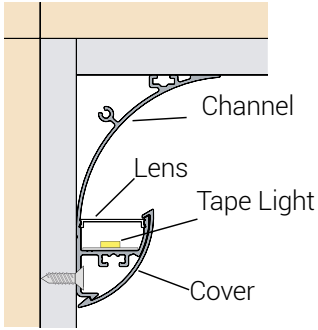

1. Position the 24V DC Class 2 power supply in a suitable location within 30 feet of the desired fixture location.

**NOTE:** Longer distances are acceptable when using a thicker 12 AWG wire.

2. Before installing the tape light in the channel, test the connection to power. If using a full spool of tape, connect one end of the tape to DC power and turn power on. If using a cut section of tape, attach the connector to the tape and then connect to DC power.

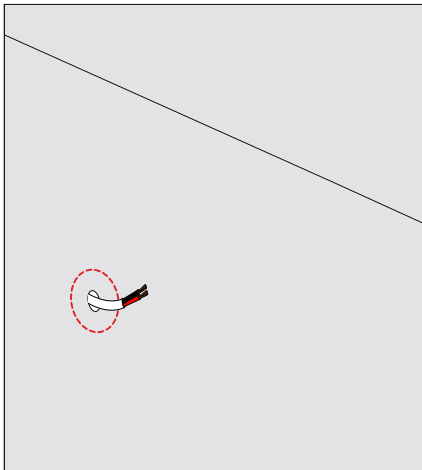

3. Bring power to a point through the wall that will match the position of the fixture's cable conduit.

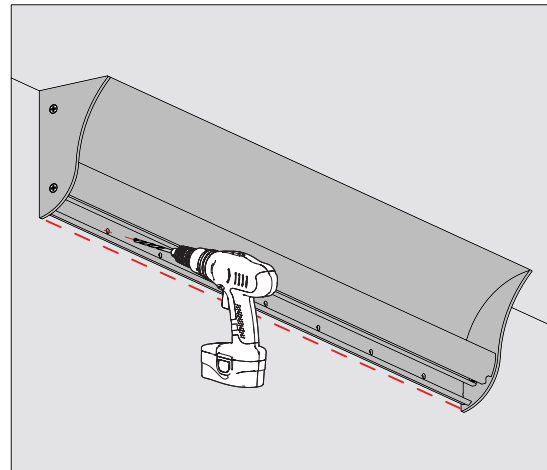

4. Drill 3/16 in. mounting holes along the drill port in the fixture to match the stud locations in the wall where Surfa Cornice 4in will be mounted. Deburr any sharp edges.

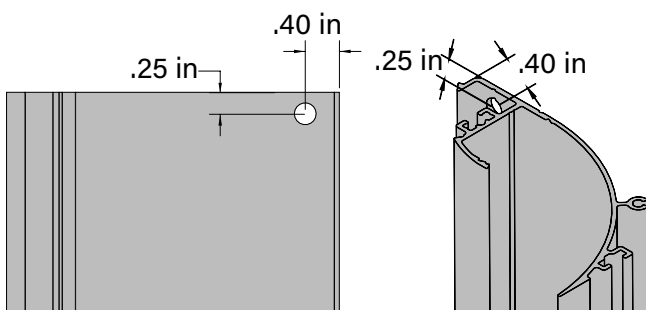

5. Drill 1/4 in. hole in the back of the Surfa Cornice 4in. channel at the location indicated above. This hole will be used for a power feed.

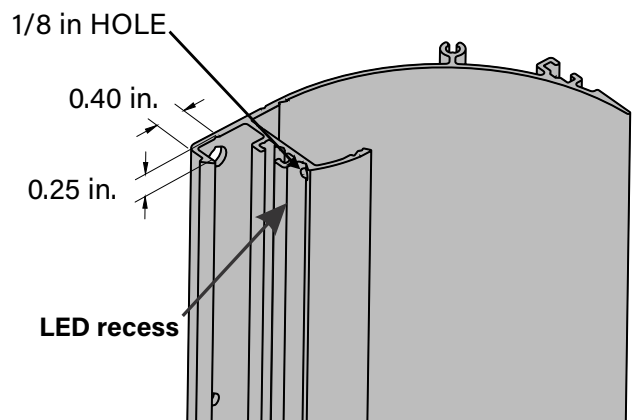

- 5a. Drill a 1/8 inch hole through the floor of the Surfa Cornice 4 in channel into the cable conduit to provide wire access from the LED recess.

**ALLOY LED** Installation Instructions  
**Surfa® Cornice 4in.- Channel**

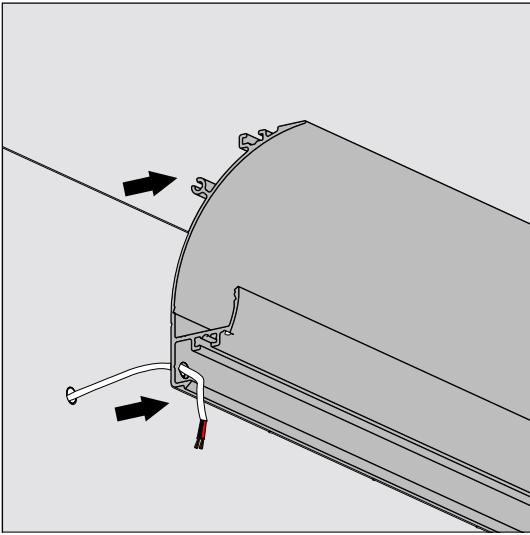

6. Ensure that the DC power cable passes into the designated hole to the cable conduit.

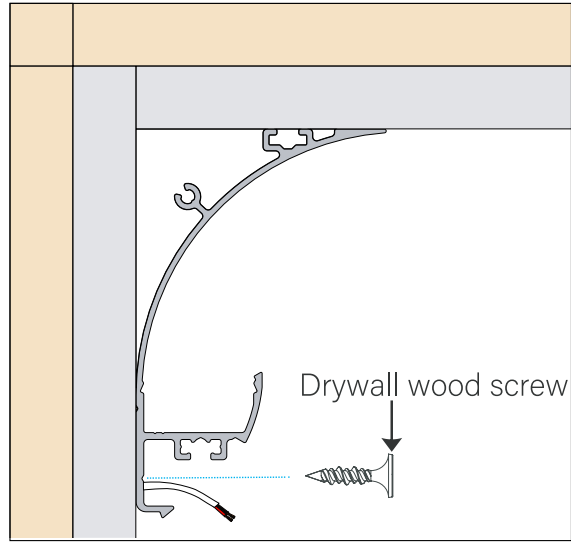

7. Select your anchoring system: drywall wood screw or #6 or #8 drywall anchor. Use standard drywall screws to fasten the fixture to the studs behind the wall. Properly secure the complete fixture to drywall by screwing through.

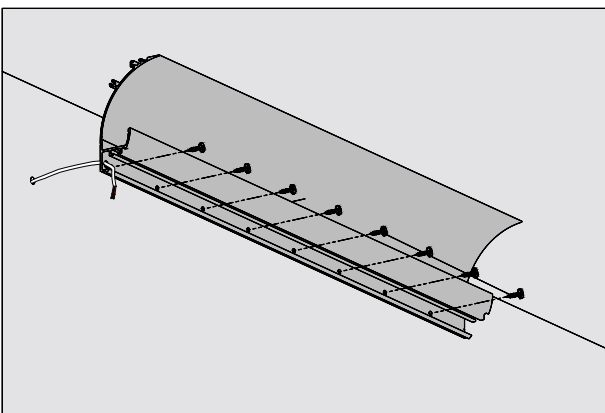

8. Align the fixture properly to match both channel and drywall hole to manage cables more easily. Make sure Cornice is installed flush at the drywall and ceiling surface.

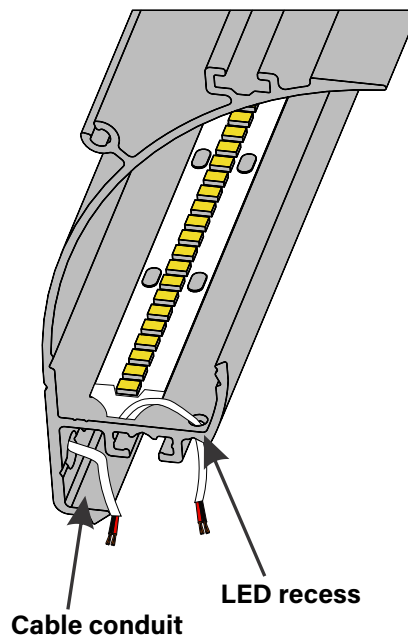

9. Backlighting Configuration  
 Remove the adhesive protector in the back of the LED tape light. Apply the tape light where indicated above. Pass the lead wire

# ALLOY LED<sup>®</sup> Installation Instructions

## Surfa<sup>®</sup> Cornice 4in. Channel

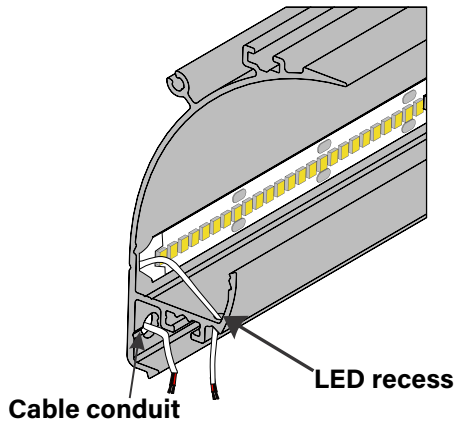

9a. Edgelighting configuration  
Remove the adhesive protector in the back of the LED tape light. Apply the tape light where indicated above. Pass the lead wire through the 1/8 in. hole.

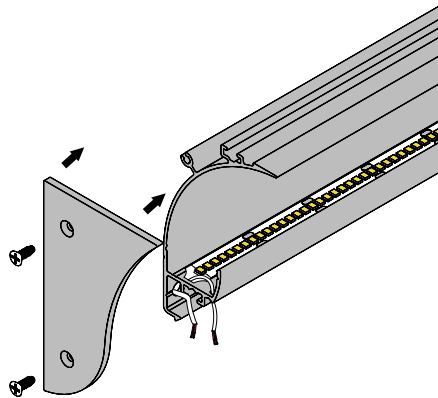

10. Assemble the end caps with provided Phillips head screws on both ends using a #2 screwdriver.

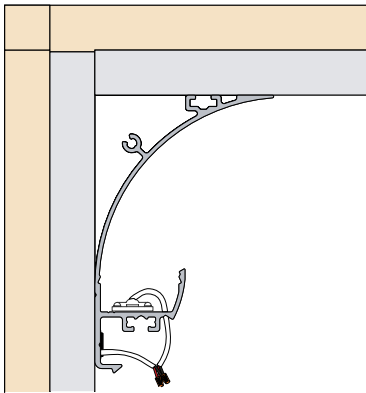

11. Connect LED tape lead to low-voltage in wall rated wire. Red is positive (+) and black is negative (-).

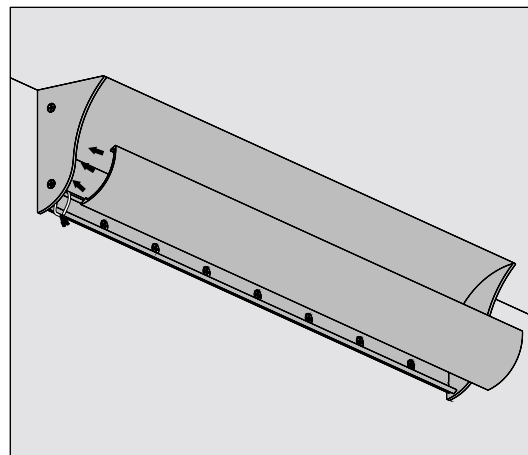

12. Secure the Cornice cover plate to the Cornice channel by snapping it into the channel grooves.

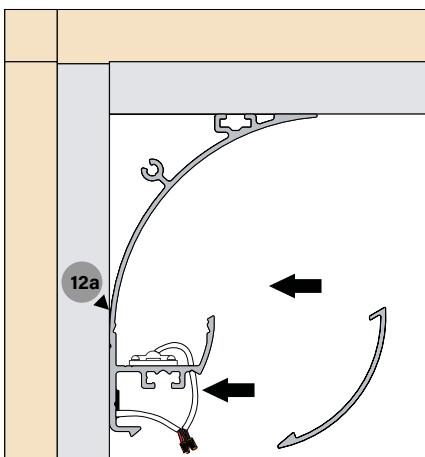

12a. Snap the Cornice cover plate channel into the Cornice channel. Place the cables inside the cable conduit.

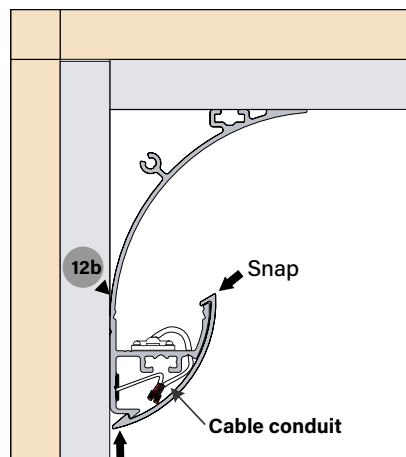

12b. Make sure the Cornice cover plate is secured firmly into the Cornice channel grooves.

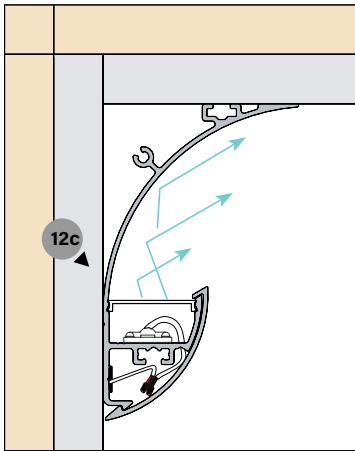

12c. Lock lens into the channel by firmly pressing one edge into the profile, then the other. Lock and continue pressing the lens along the fixture until it is fully seated.

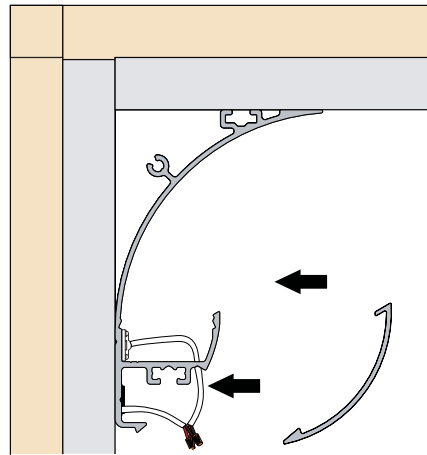

13. Edgelighting Configuration  
Snap the Cornice cover plate channel into the Cornice channel. Place the cables inside the cable conduit.

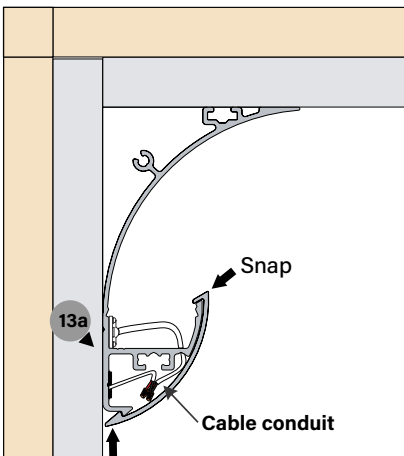

13a. Make sure the Cornice cover plate is secured firmly into the Cornice channel.

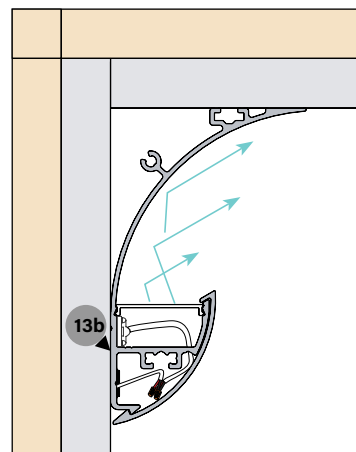

13b. Lock lens into the channel by firmly pressing one edge into the profile, then the other. Lock and continue pressing the lens along the fixture until it is fully seated.