

FocaLine 6 Flexible Grazer

SAFETY & TIPS

DO NOT CONNECT 24V DC TAPE LIGHTS DIRECTLY TO 120V AC POWER.

- Tape light should ONLY be powered by a UL Listed Class 2 DC 24V power supply.
- ALWAYS install in accordance with local and national electrical code regulations.
- This product should be installed and serviced by a qualified, licensed electrician.
- Do not install where diodes can be exposed to direct sunlight as this can damage the diodes, reduce their operational life span and alter their operational characteristics.
- Do not install the product in a location where the ambient temperature is outside the listed ambient temperature range of the product. Failure to do so could result in damage to the tape light and may alter the tape light's operational characteristics.
- Do not exceed the listed maximum run of the product, which is shown on the product packaging. Each maximum run requires a dedicated power feed from the driver.
- Do not overload the 24V DC power supply. Overloading the power supply may cause shorting, overheating, and possibly fire.
- Do not stare directly into LED lights when illuminated.
- Always disconnect the power supply before cutting or connecting tape light.
- Apply power to test the tape light and connections before mounting.
- Do not expose dry location tape light to direct or indirect moisture.
- Do not crimp tape light, attempt to bend tape light widthwise or lengthwise to a radius less than 0.6 in. / 15 mm.

INSTALLATION METHODS

- Installation using **Mounting Clips** (AL-01-76-9981-AL)
- Installation using the **Surface-Mount Channel Kit** (AL-01-76-9924-KIT-BL)

CONNECTING FOCALINE 6 TO POWER

- 1 Connect FocaLine 6 to a low-voltage class II power supply and power it on.
 - 1a. Insert the pins into the gap between the FocaLine 6 light engine and casing, ensuring a secure connection. Ensure that tape light illuminates.
 - 1b. Hold FocaLine 6 vertically and use silicone to fill the gaps. Apply silicone around the connector.

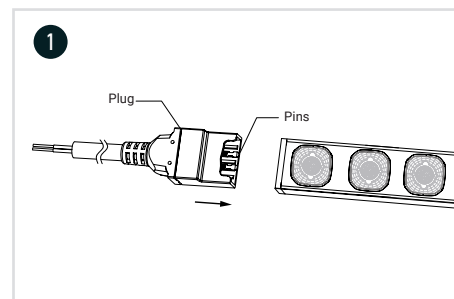

INSTALLATION OF FOCALINE 6 USING MOUNTING CLIPS

- 1 Remove the metal mounting clips and screws from the box. Mark the location of each mounting clip on the surface Focaline 6 will be mounted to with a pencil.

Mounting clips should be placed 2 ft. apart from each other and 0.5 in. away from the surface to be grazed.
- 2 Secure the mounting clips to the marked location using the provided screws.

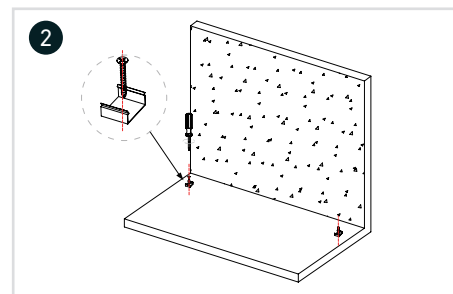

Instructions continue on next page.

ALLOYLED® Installation Instructions

- 3 Snap FocaLine 6 into the mounting clips by pressing gently.

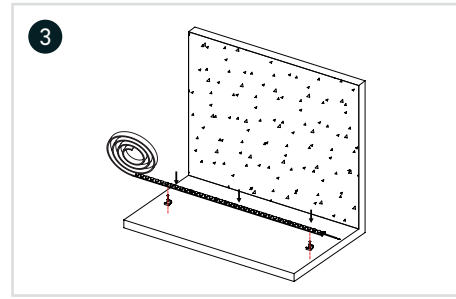

INSTALLATION OF FOCALINE 6 USING THE SURFACE-MOUNT CHANNEL KIT

The Surface-Mount Channel kit includes: 1 Black Aluminum Channel (4 ft.), 1 Premium Clear Cover, 2 Black Channel End Caps, 7 Inner Clips, 4 Metal Mounting Clips/Screws for the Channel, and 2 Metal Straight Connectors (for optional extension using another kit)

(Optional) Instructions for Straight Connectors to Connect Focaline 6 Channels

- A. Remove the black aluminum channel from the kit. Place the channel face down so that if FocaLine 6 was installed, it would be shining at the ground. Slide the provided straight connectors into the two available slots.
- B. Slide the connecting aluminum channel to sit flat against the end of the first channel. Bring channels together ensuring both straight connectors are seated in the grooves such that the middle of each linker is aligned with the seam in the channels. Tighten the screws to secure into place.

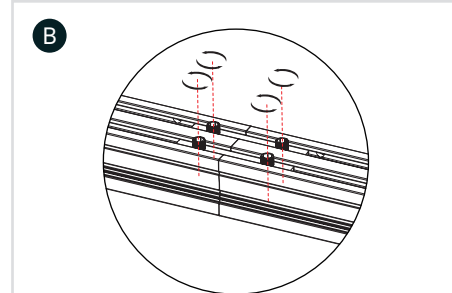
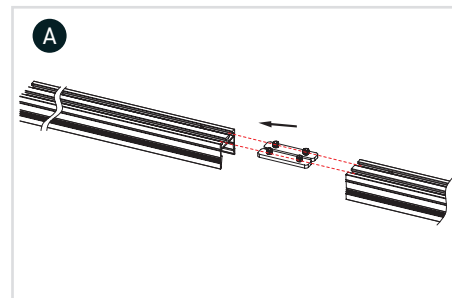

Instructions for Adjustable Mounting Bracket (Sold Separately)

- 1 Mark the location of each adjustable mounting bracket on the surface Focaline 6 will be mounted to with a pencil.
The adjustable mounting bracket should be placed 2 ft. apart from each other and 0.5 in. away from the surface to be grazed.
- 2 Secure the adjustable mounting brackets to the marked location using the provided screws.
- 3 Remove the black aluminum channel from the kit. Fix the channel into the rotating accessory, securing the bracket to the edge of the channel with a hexagonal screwdriver.

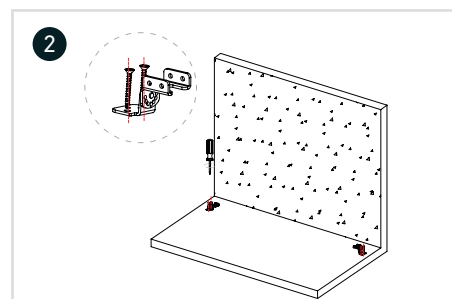

Instructions continue on next page at step 4.

Instructions Using Metal Mounting Clips (Included)

- 1 Remove the channel metal mounting clips and screws from the box. Mark the location of each mounting clip on the surface FocaLine 6 will be mounted to with a pencil.

Mounting clips should be placed 2 ft. apart from each other and 0.5 in. away from the surface to be grazed.

- 2 Secure the mounting clips to the marked location using the provided screws.

- 3 Remove the black aluminum channel from the kit. Snap the channel into the mounting clips by pressing gently.

- 4 Press the provided inner clips into the black aluminum channel and snap into place. Be sure to evenly distribute the inner clips across the channel.

Inner clips should be placed every 6 in.

- 5 Lay FocaLine 6 across the channel. Starting from the end, press FocaLine 6 into the inner clips to secure into place.

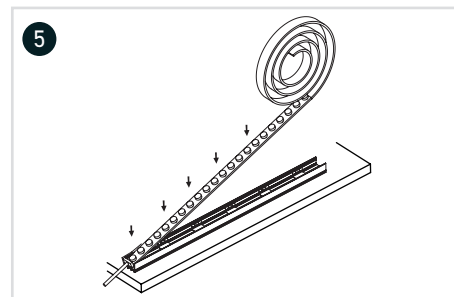
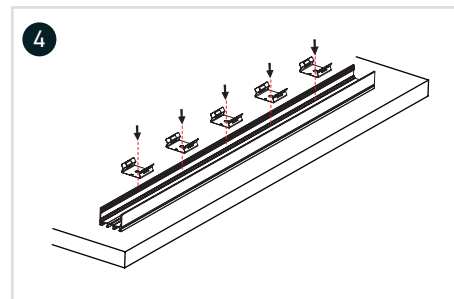
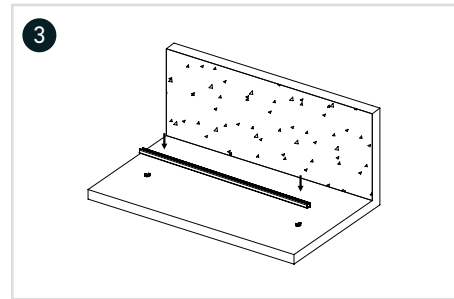
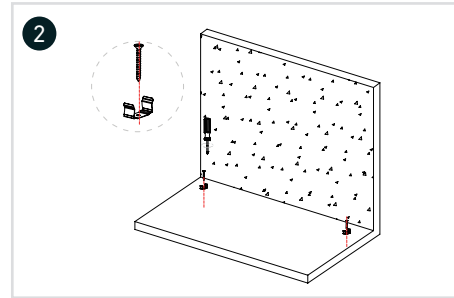

(Optional) Anti-Glare Louver Instructions (Sold Separately)

- A. Place the anti-glare louver over FocaLine 6 to align with the diode compartments.
- B. Secure the anti-glare louvers by pressing down until it snaps into place.

Instructions continue on next page.

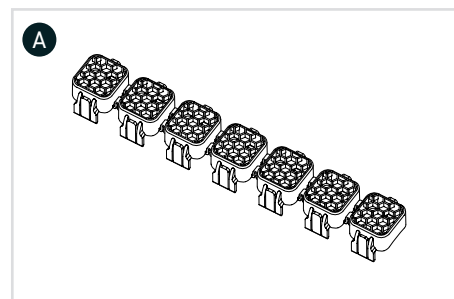

ALLOYLED® Installation Instructions

- 6 Slide the open-end cap along the power cable until it reaches the end of the channel. Fix into place by pushing the grooves into the channel and applying glue to secure. Repeat on the other side with the closed-end cap. Ensure that the end caps are fitted flat on both ends.
- 7 Align the end of the provided premium clear cover with the end of the aluminum channel. Press down firmly across the clear cover to secure it into place. Peel off the protective film layer.

